

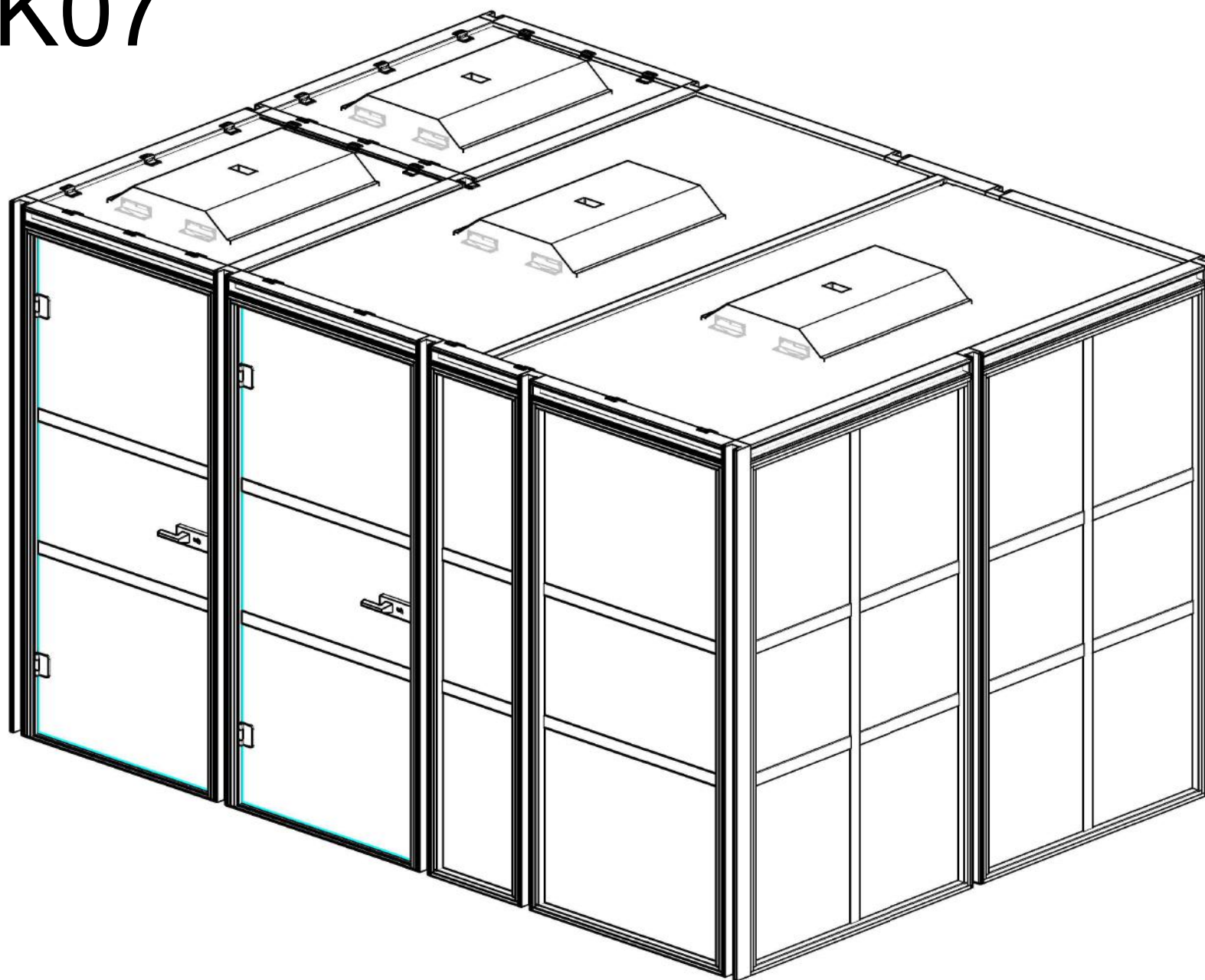

HK07



1

M6x16



M6x16

2

Ø4.2x16

A detailed illustration of a screw with a cross-shaped head and a threaded shaft. The screw is shown at an angle, pointing towards the bottom right. The head is circular with a cross-shaped indentation in the center. The shaft has several threads visible.

Ø4.2x16



2h

HK07

A

3

1

2

4

?

90°

1

B

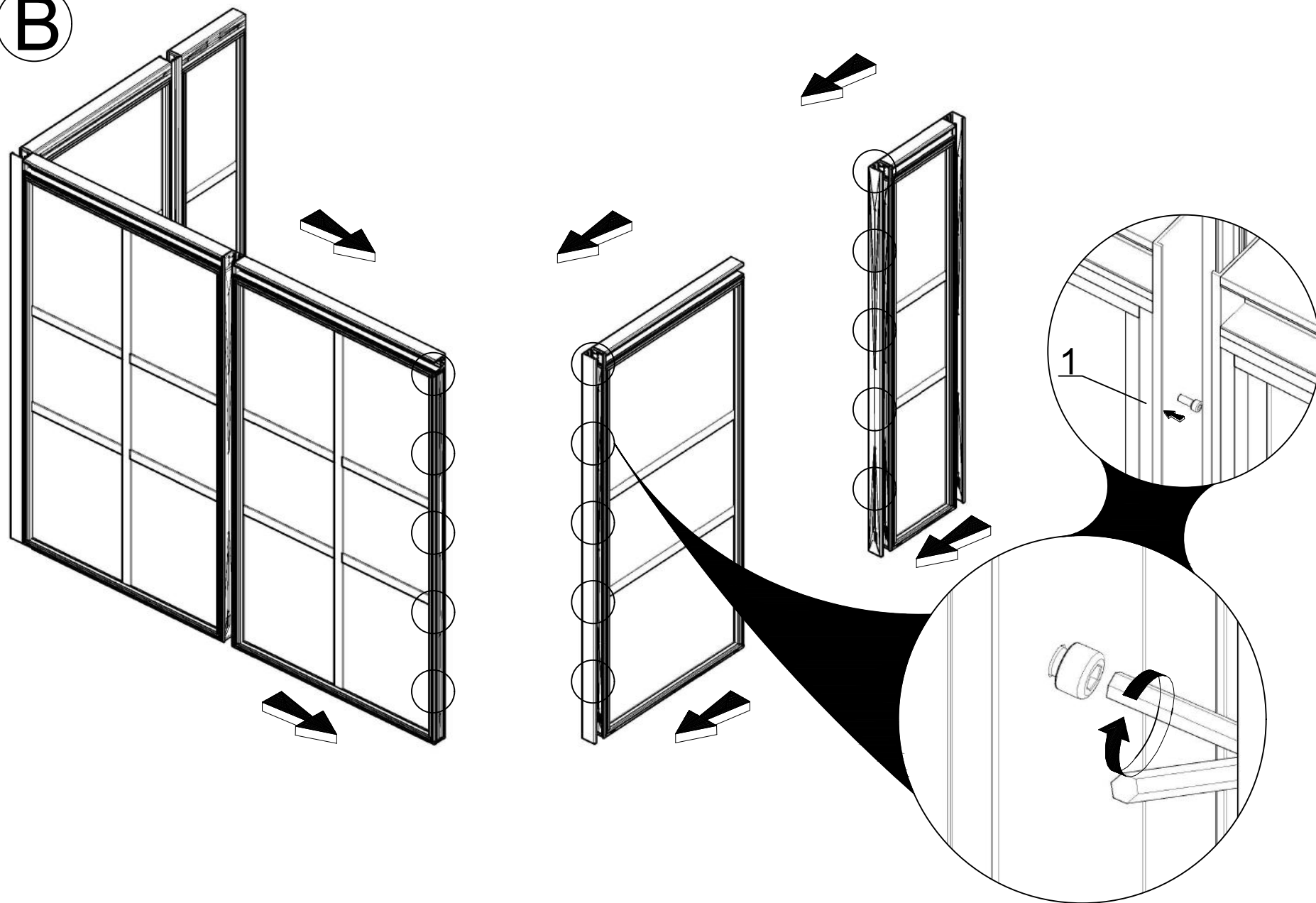

C

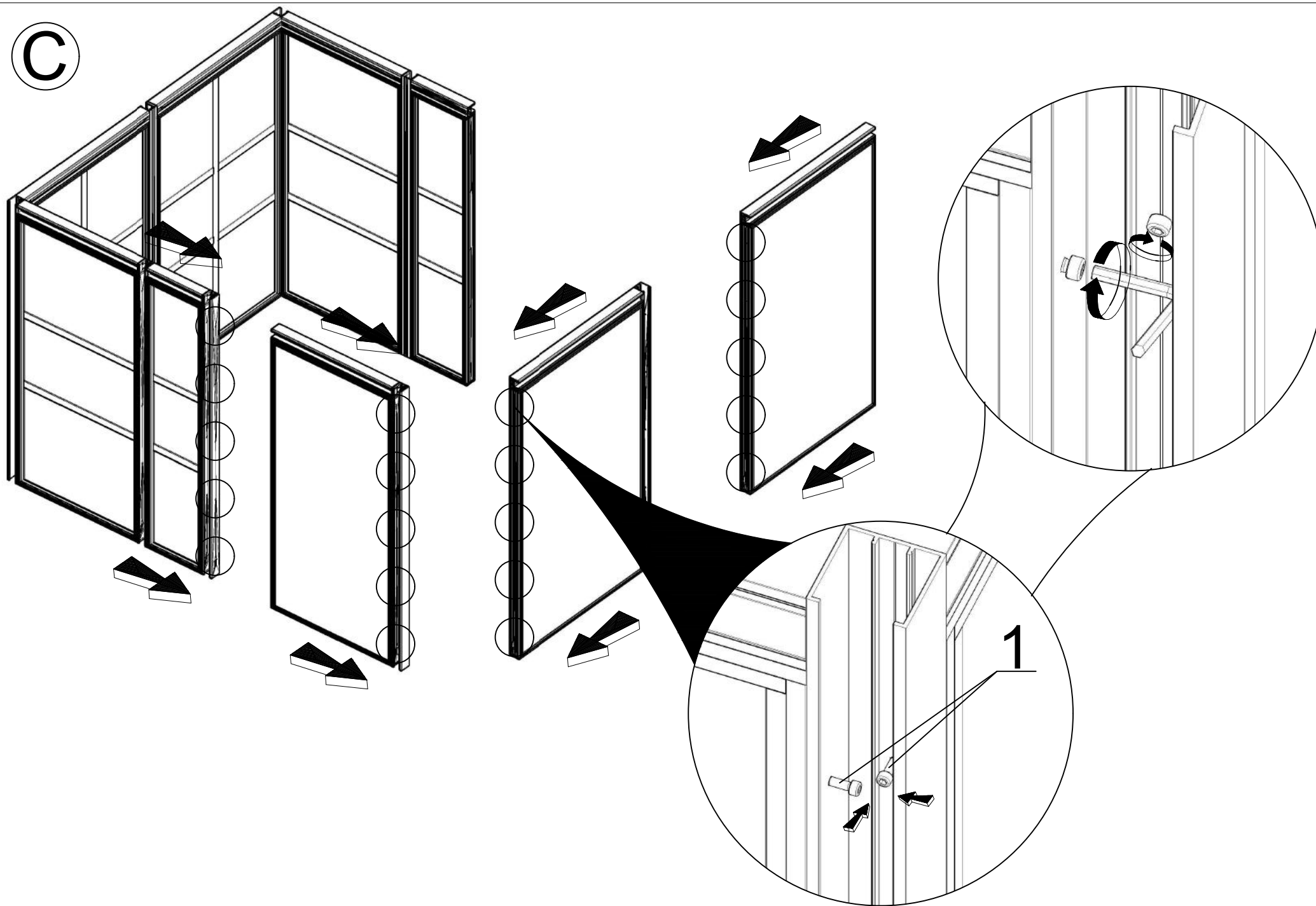

D

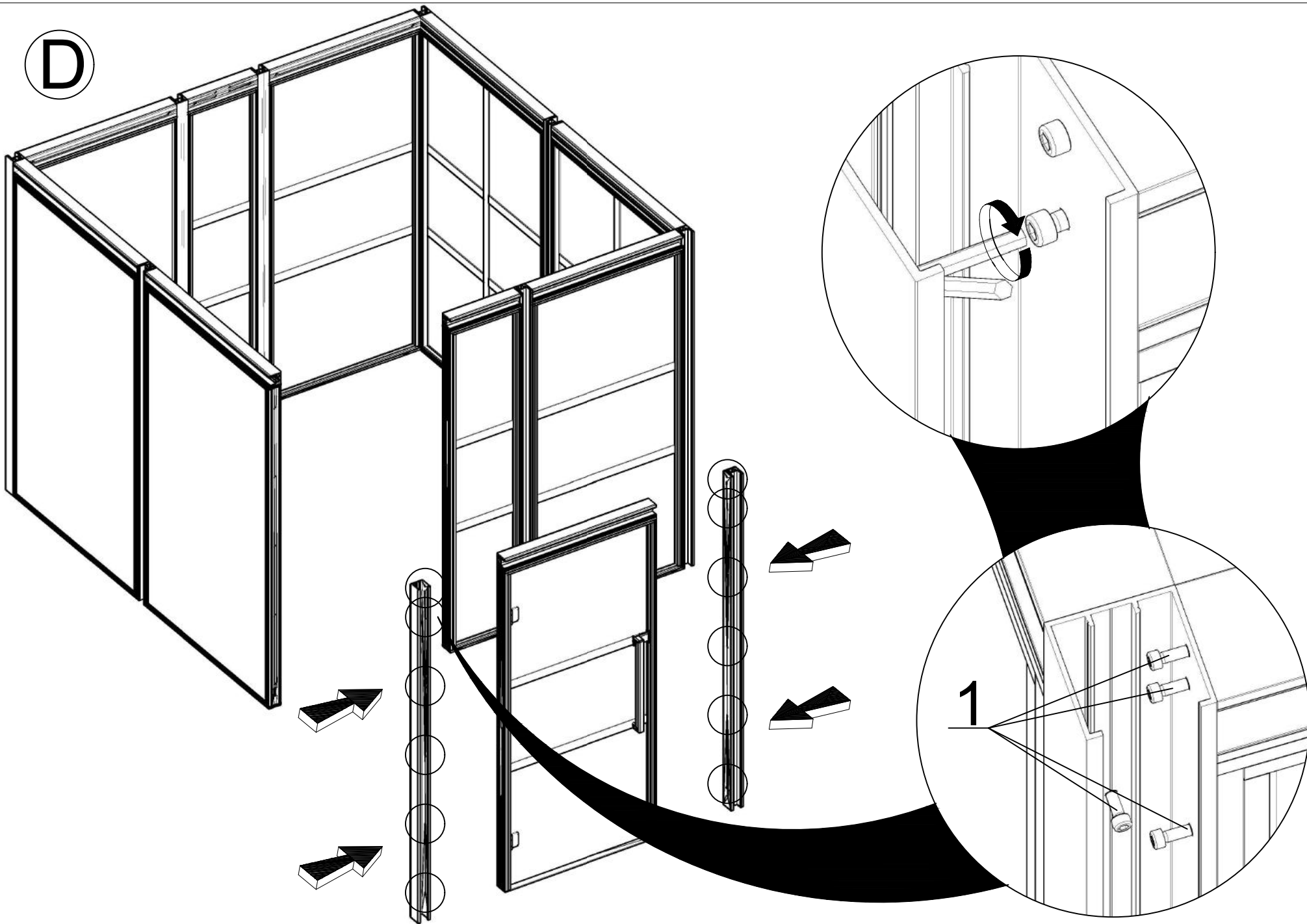

E

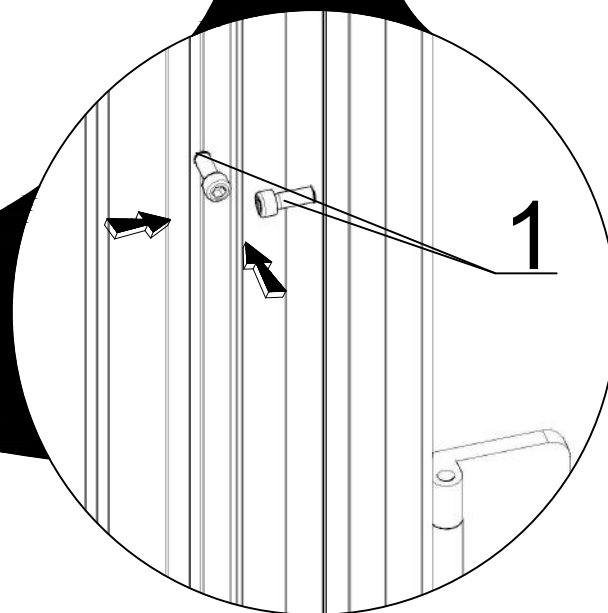
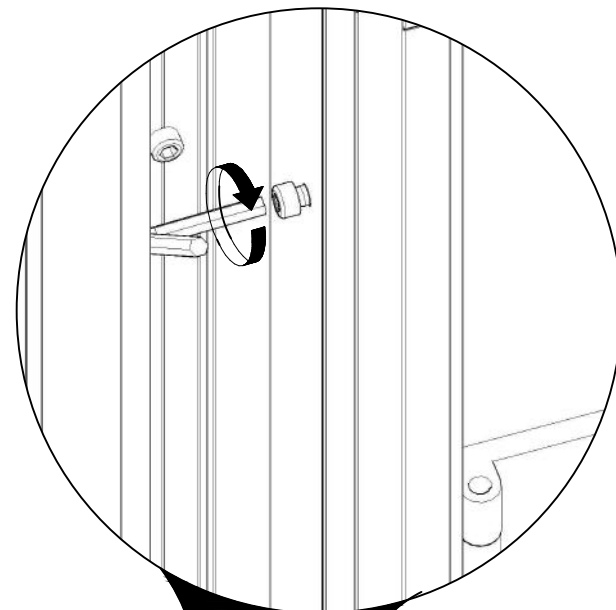
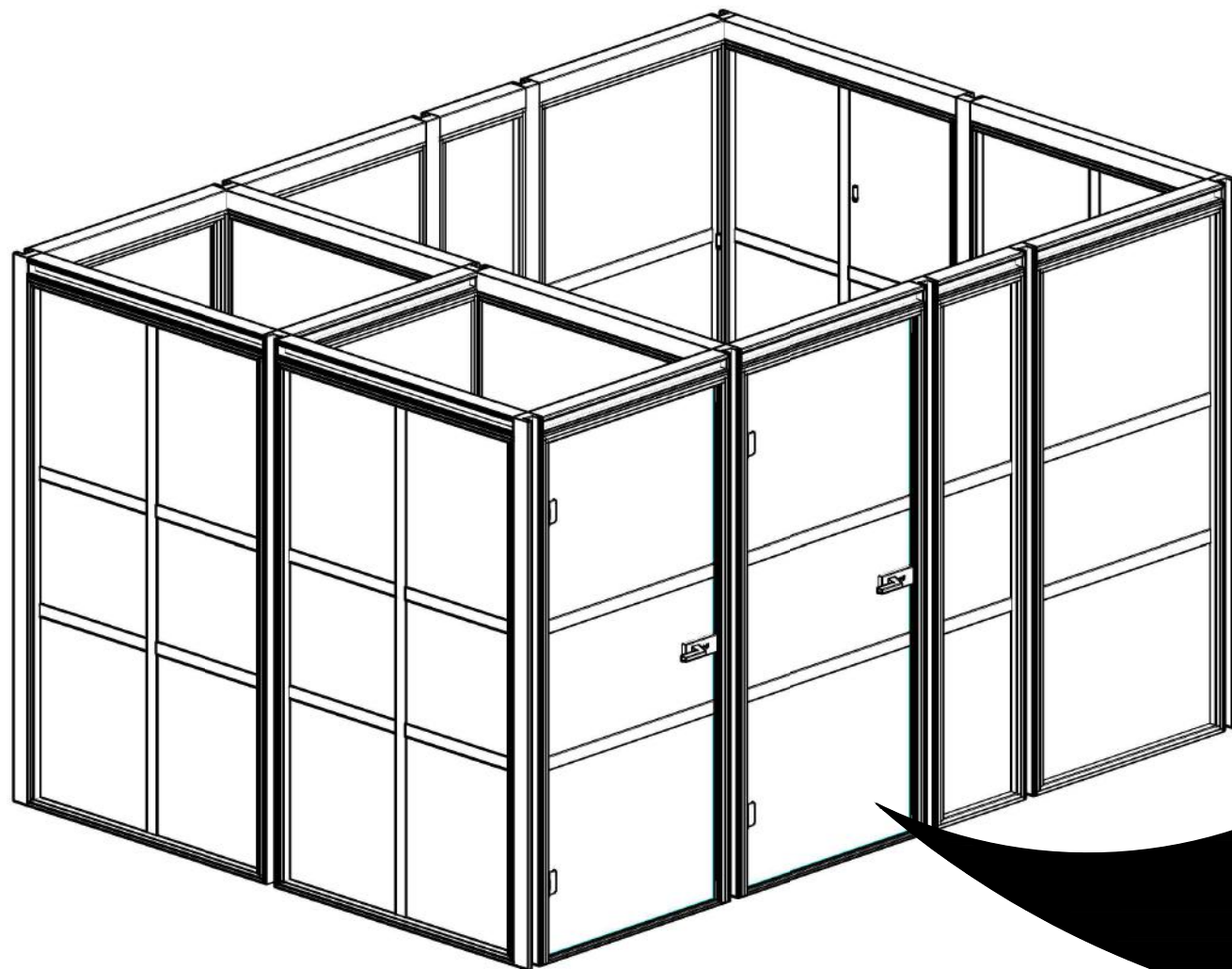

F

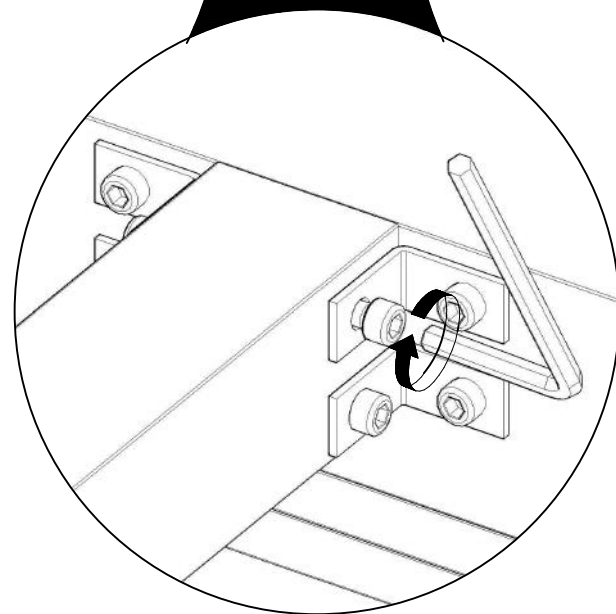
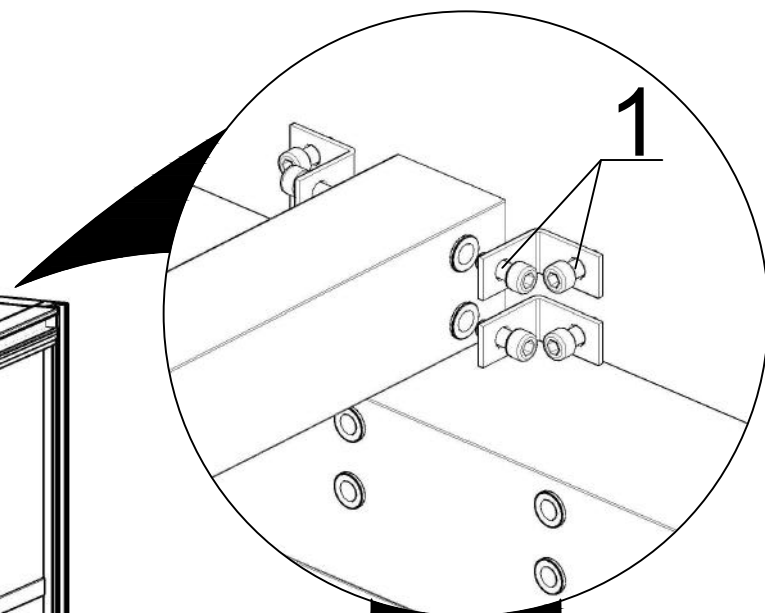
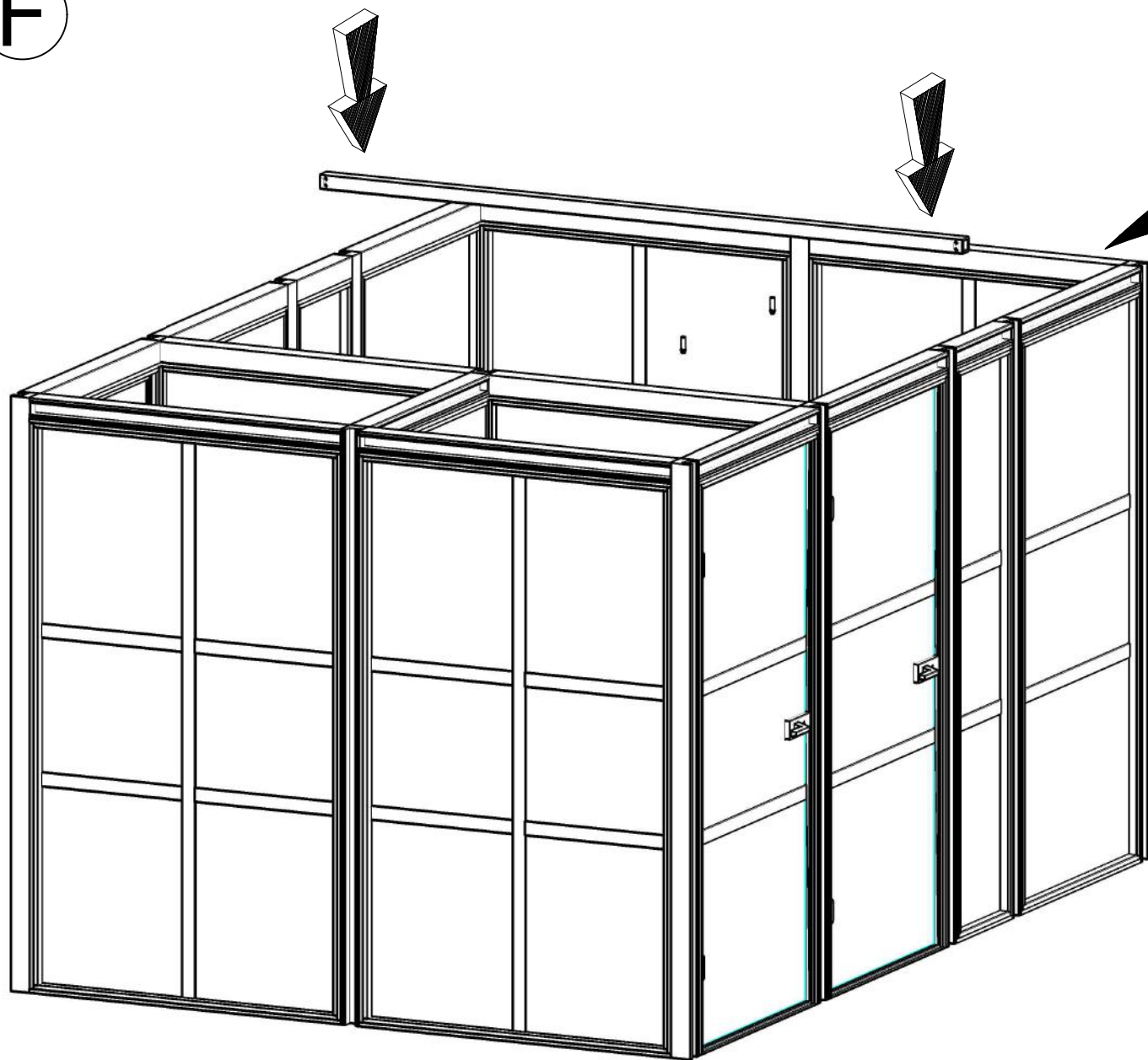

G

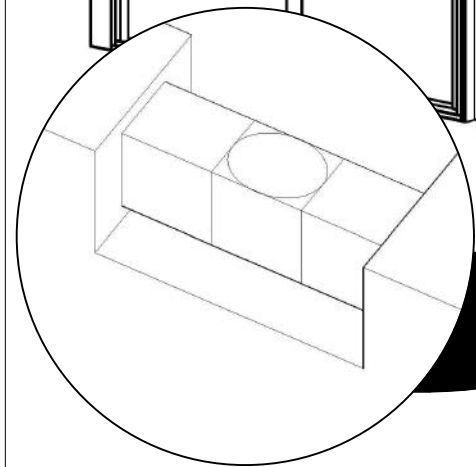
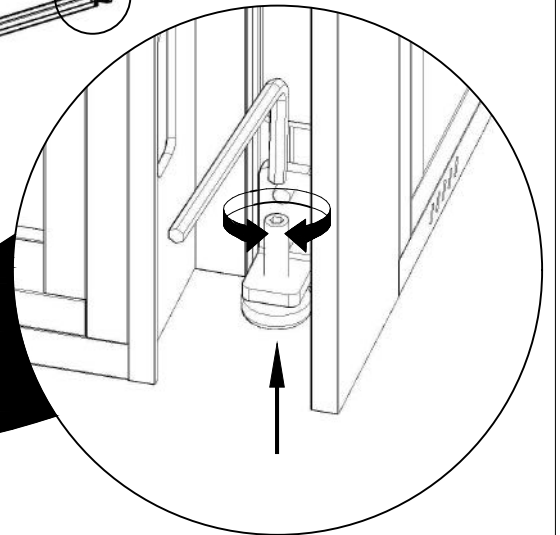
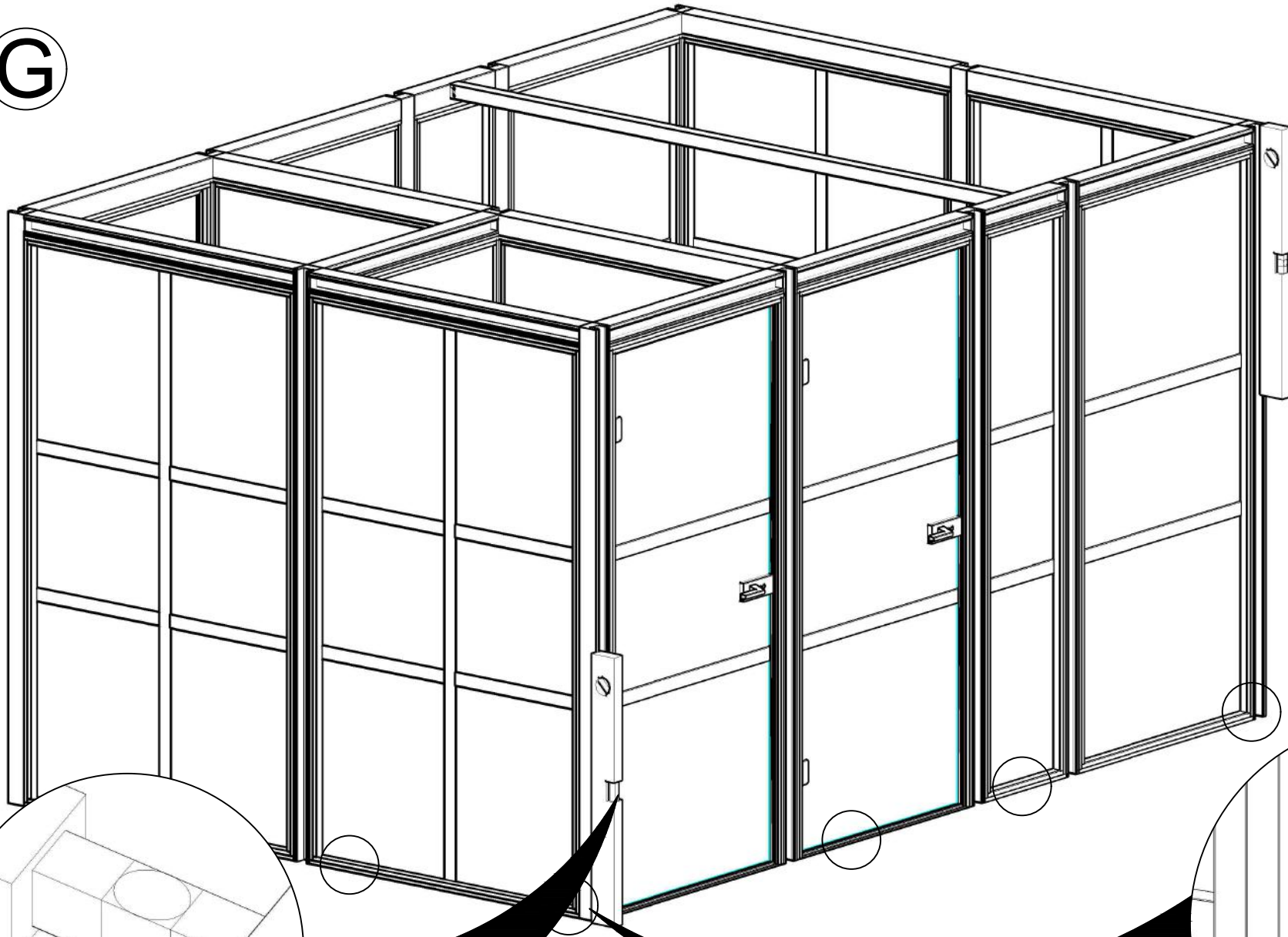

H

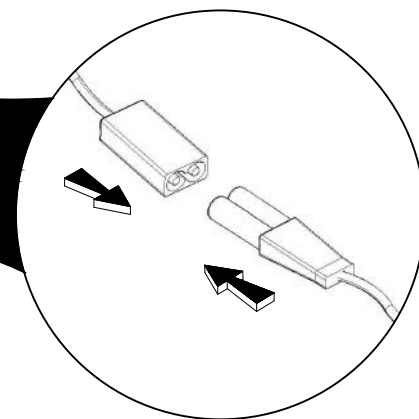
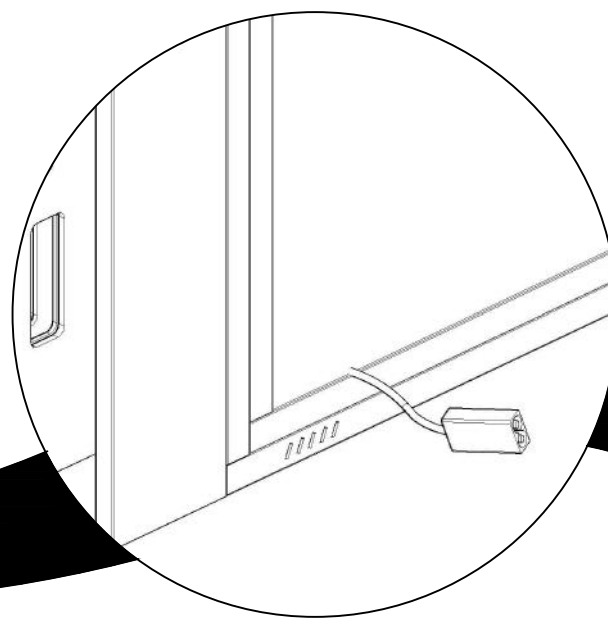
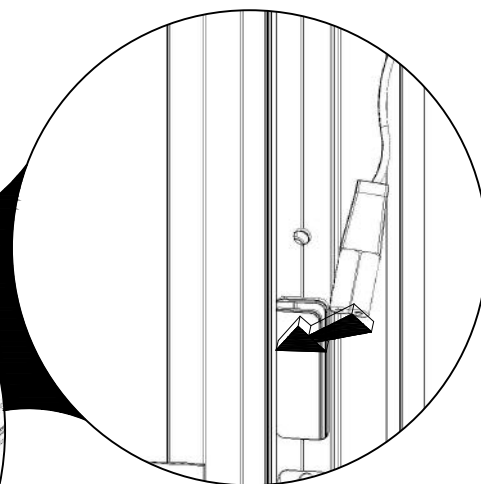
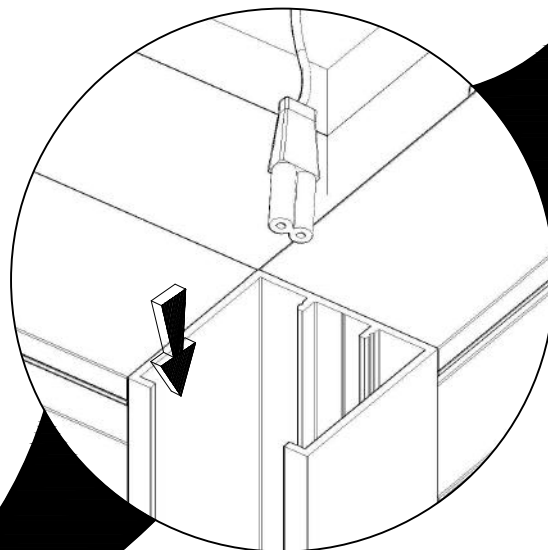
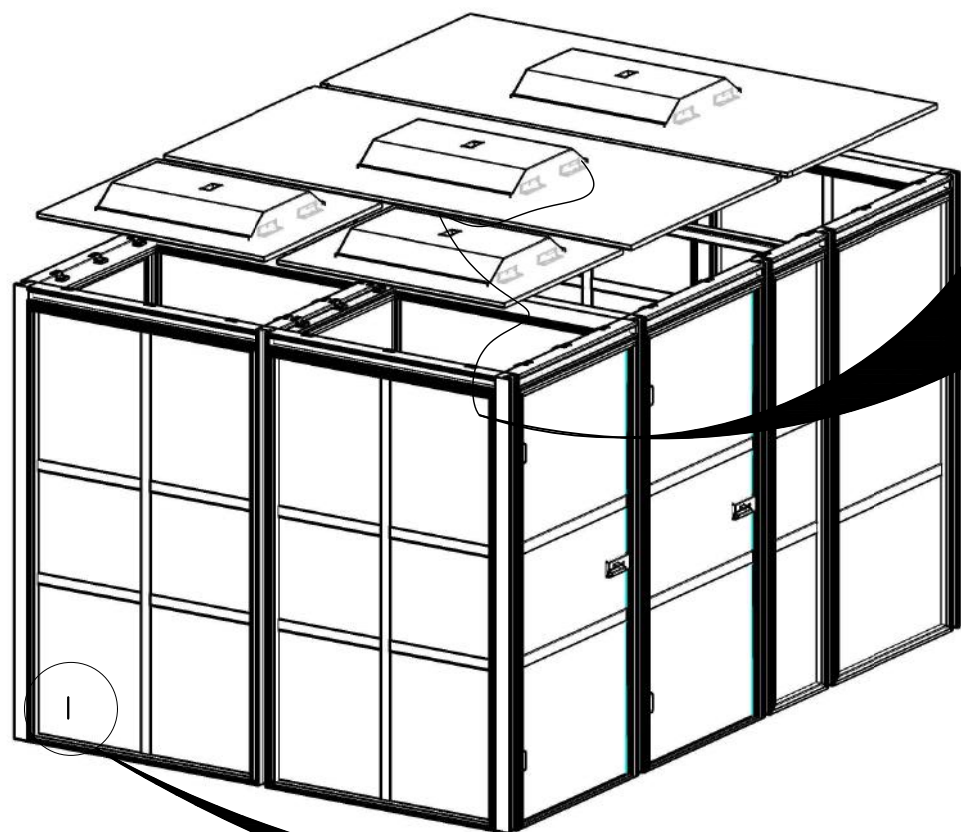

I

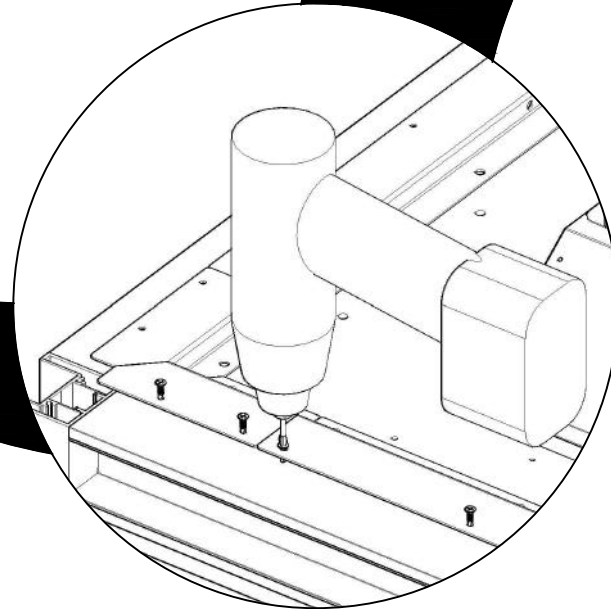
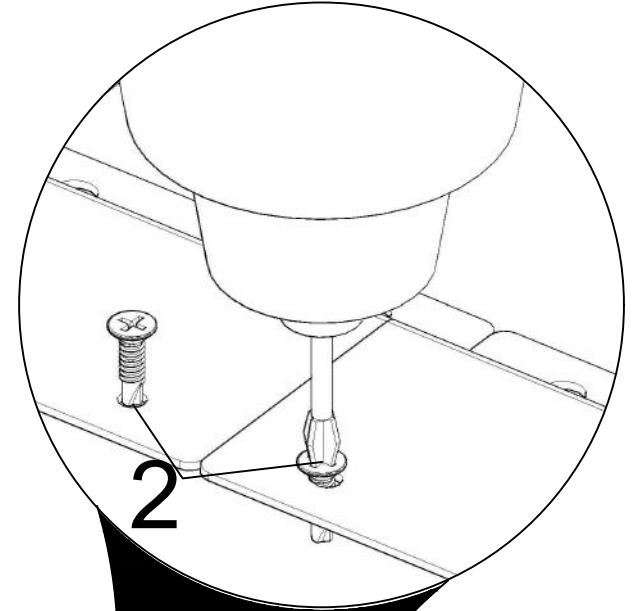
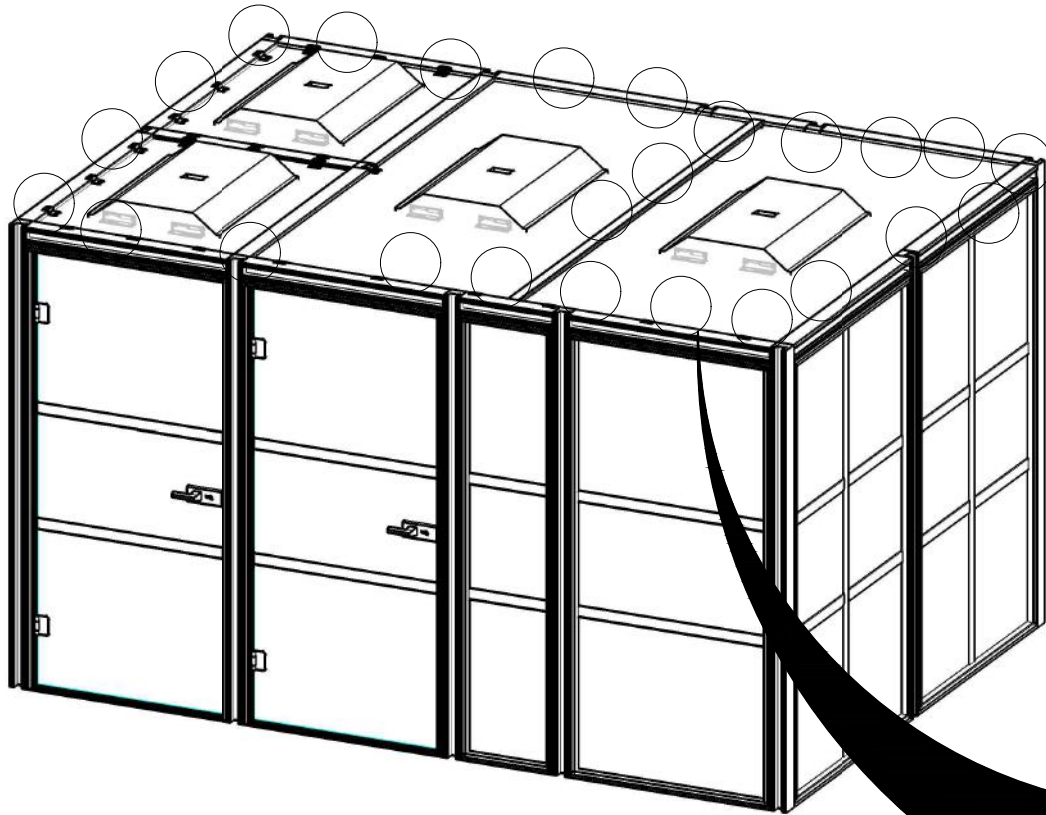

J

